

EPH-XXX-04828
3/8" BOTTOM W/WIPE

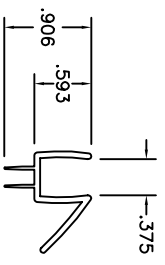

EPH-N00-04829
3/8" BOT. W/DRIP

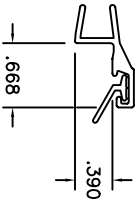

EPH-N00-04830
3/8" 180° STRIKE & DOOR JAMB

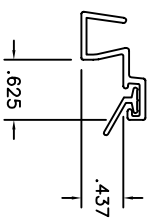

EPH-N00-04831
3/8" 90° STRIKE JAMB

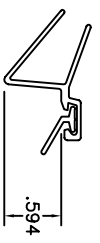

EPH-N00-04832
3/8" 135° STRIKE JAMB

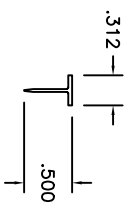

EPH-N00-04833
TEE

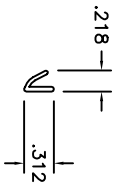

EPH-N00-04834
ANGLE VINYL

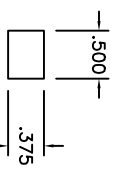

EPH-XXX-04836
3/8" X 1/2" X 2" SETTING BLOCK

1/2 SIZE DETAIL

NOTE: Glazing material for all KD units and Glazed units must conform to Ansi Z97.1 and CPSC Standard 16 CFC 1201 Category I and II.

XPOLYCARB.DWG
DATE: 4-1-99

SERIES	MODEL	UNIT WIDTH X HEIGHT	DOOR GLASS SIZE
--------	-------	---------------------	-----------------

DESIGNLINE POLYCARBONATE DETAILS			
--	--	--	--



ALUMAX
BATH ENCLOSURES

a product of ALCOA
PO Box 40 - Magnolia, AR 71754-0040 - (870) 234-4260