

180° POLYCARBONATE STRIKE

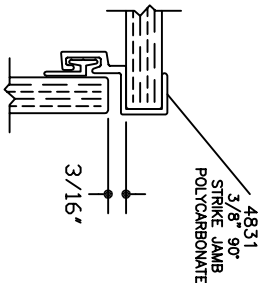

90° POLYCARBONATE STRIKE

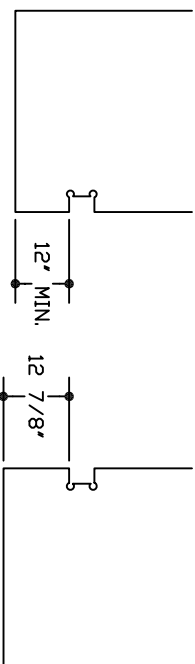

GLASS DOOR

GLASS PANEL

When running channel under the door also, the panel hinge notch is 7/8" farther from the edge of the glass than on the door.

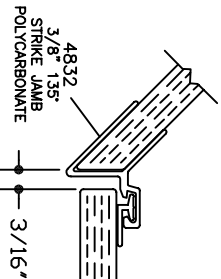

135° POLYCARBONATE STRIKE

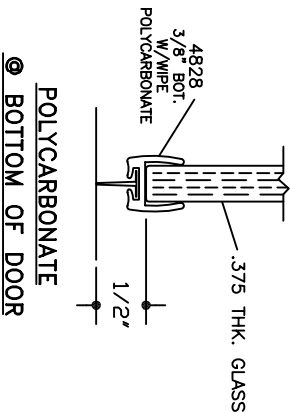

POLYCARBONATE  
⊙ BOTTOM OF DOOR

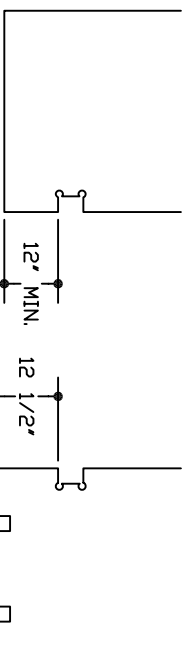

GLASS DOOR

GLASS PANEL

When installing panel with clips, panel hinge is 1/2" farther from the edge of the glass than on the door.

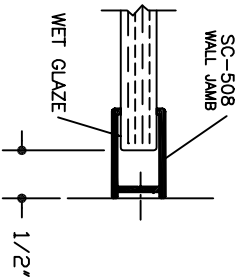

WALL JAMB

1/2" SIZE DETAIL

NOTE: Glazing material for all KD units and Glazed units must conform to Ansi Z97.1 and CPSC Standard 16 CFC 1201 Category I and II.

XHGOPTIONS.DWG  
DATE: 9-23-99

<b>SERIES</b>	<b>MODEL</b>	<b>UNIT WIDTH x HEIGHT</b>	<b>DOOR GLASS SIZE</b>
<b>DESIGNLINE</b>			
<b>HEAVY GLASS OPTIONS</b>			

**ALUMAX**  
BATH ENCLOSURES  
a product of ALCOA  
PO Box 40 - Magnolia, AR 71754-0040 - (870) 234-4260